

ITEM #	Part Number	Description	QTY.
1	WHLTWB	BASE, TAIL WHEEL	1
2	WHLTW-19	BUSHING, HAT	2
3	MSCU625-0210	WASHER, CURVED	2
4	MSC.625SAE	WASHER, 5/8	2
5	MSC.62-18HEXNUT/SLOTTED	NUT, HEX SLOTTED	2
6	MSC.625-18X4BOLT(A)	AXLE, VERTICAL	1
7	MSC.11x1.5COTTERPIN	PIN, COTTER ZINC	2
8	WHLBSP4	SPACER, 4"UL BRAKE	2
9	WHLTW-2	WASHER, BRONZE	1
10	WHLT-02	ARM, TAIL WHEEL	1
11	WHLTW-6F	FORK, 6" TAIL WHEEL	1
12	WHLTW-21	BUSHING	1
13	MSC.25-20x.50	BOLT, SHCS .25-20X.50	1
14	WHLT-03	Wing, Tail Wheel	2
15	MSC.750X.443X.062WASHER	Washer, Nylon	2
16	MSCAN960-10	WASHER, THICK	6
17	MSCB0375-020	WASHER, BELLEVILLE	2
18	MSCAN3-6	BOLT,HEX DRILLED	2
19	MSCAN310-3	NUT, CASTLE	2
20	MSC.062X.50COTTERPIN	PIN, COTTER ZINC	2
21	MSC.50-13X3.0SHCS(A)	BOLT, SHCS .50-13X3.0 PLATED	1
22	WHLTW-3	SPACER, TAIL WHEEL	1
23	WHLT6SL	SLEEVE, TAIL T-6P	1
24	WHLW35/.625	WHEEL HALF, TAIL VALVE	1
25	WHLTW35/.625	WHEEL HALF, TAIL BACK	1
26	MSCAN960-10L	WASHER, THIN	6
27	MSCAN3-15A	BOLT, HEX	3
28	MSCMS21045-3	NUT, FLEX LOCK	3
29	MSC1623DCTN	Bearing, Ball 0.625	2
30	MSCAN960-816L	WASHER	1
31	MSC.50-13NYLOCK	NUT, NYLOCK	1
32	TIRTU6X2	TUBE, 6X2	1
33	TIRT6X2	TIRE, 6X2	1
34	TW35WGT	WEIGHT, BALANCE	2

Balance Weight #34 Installs on #27 Opposite Valve Stem

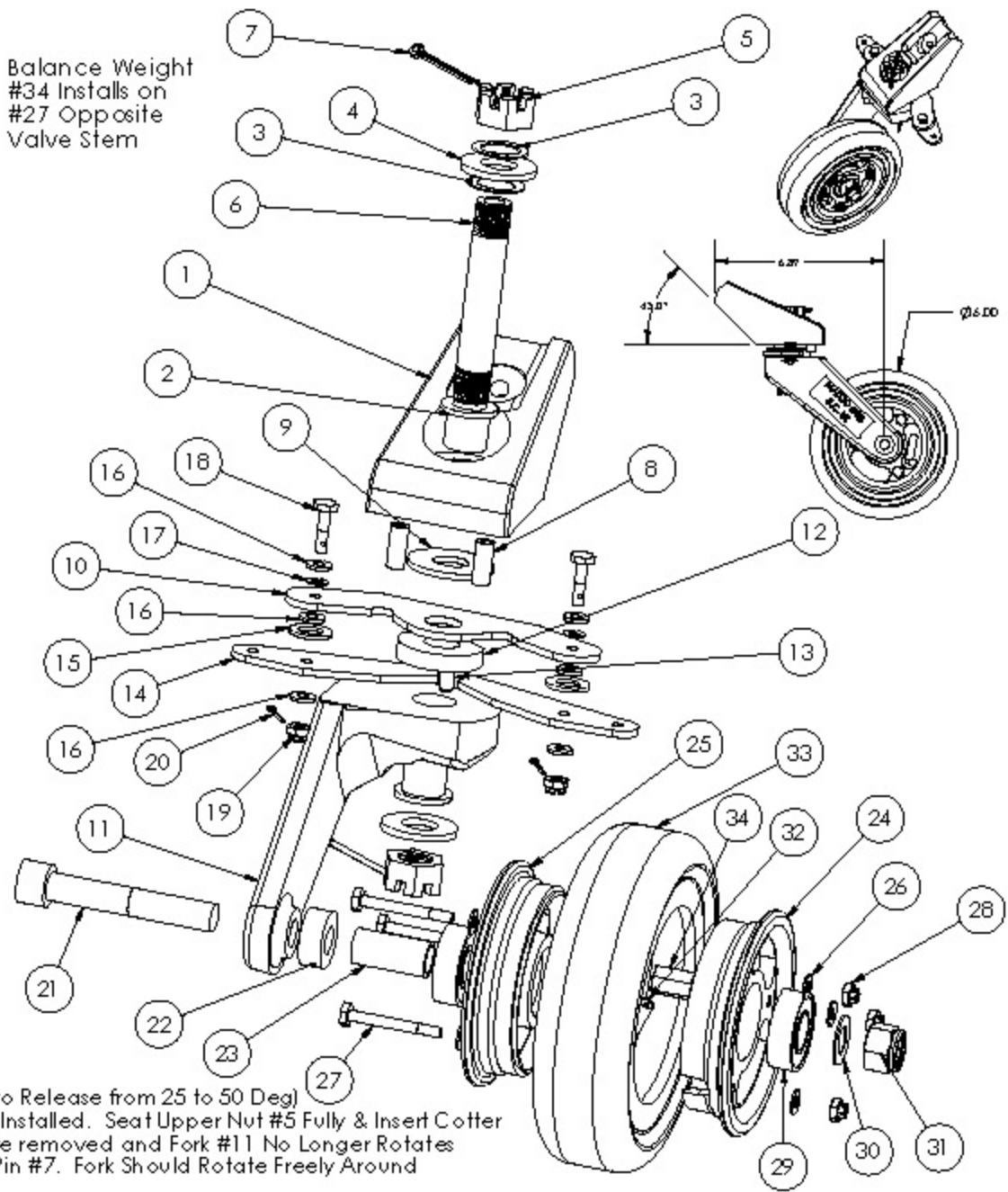

Note: Alternate Wing Available to Provide Earlier Steering Release.
 Release with Standard WHLT-03 = +/- 45 Deg
 Release with Optional WHLT-03A = +/- 25 Deg (May be Hand Ground to Release from 25 to 50 Deg)
 TO SET PRELOAD IN VERTICAL AXLE #6: Be certain #3 Springs Are Installed. Seat Upper Nut #5 Fully & Insert Cotter Pin #7. Tighten Lower Nut #5 Slowly Until All Freeplay of Springs #3 are removed and Fork #11 No Longer Rotates Freely. Loosen Lower Nut #5 2-3 Locking Features and Install Cotter Pin #7. Fork Should Rotate Freely Around Complete Rotation.

MATCO mfg		NOMENCLATURE TAIL WHEEL, 5" PNEUMATIC		PART NUMBER WHLT-6P		SCALE 1:4		TOLERANCES (EXCEPT AS NOTED)	
550W 3615 South Salt Lake City, Utah 84115 USA		MATERIAL VARIOUS		DRAWING NO. TAIL/3D-T6P		REVISION NC		Est. Wt. (lb) 4.83	
DRAWN BY George R. Happ		FINISH VARIES		DATE 3/20/2006		CHECKED BY		DO NOT SCALE DRAWING LINEAR .XX = + .03 .XXX = + .01 ANGULAR ± 1/2 CONCENTRIC ± .01	
				SHEET 1 OF 1		SHEET SIZE A			