

NO.	INVENTORY NO.	PART NAME	REQ'D
1	MC7-L	ACTUATOR LEVER	1
2	MC7YOKE	CYLINDER YOKE	1
3	3000-X75	SNAP RING	1
4	2-012	O-RING	1
5	222P-S	FITTING, BRASS	1
6	MC7-1	SHAFT	1
7	0600-0101-10	STAT-O-SEAL	1
8	2-112	O-RING, PISTON	1
9	MC-16	SPRING GUIDE	2
10	MSC0480-055-2250M	SPRING	1
11	MC7H	HOUSING	1
12	2-113	O-RING	1
13	MCP.688(B)	PISTON	1
14	MSC.25-20X1.25SHSB	SHOULDER BOLT	1
15	MSC.25-20NYLOCK	NYLOCK NUT	1
16	MC7-PPIN	PIVOT PIN	1
17	5100-25	SNAP RING	1
18	MC6-2	CLAMP	1
19	MSC10-24X.75SHCS	SOCKET HEAD SCREW	2
20	AN960-416L	WASHER	1
21	C0300-026-0440M	VALVE SPRING	1
22	268P	STRAIGHT FITTING	1
23	MC7-2	END GLAND	1
24	269P	90 DEG FITTING	1

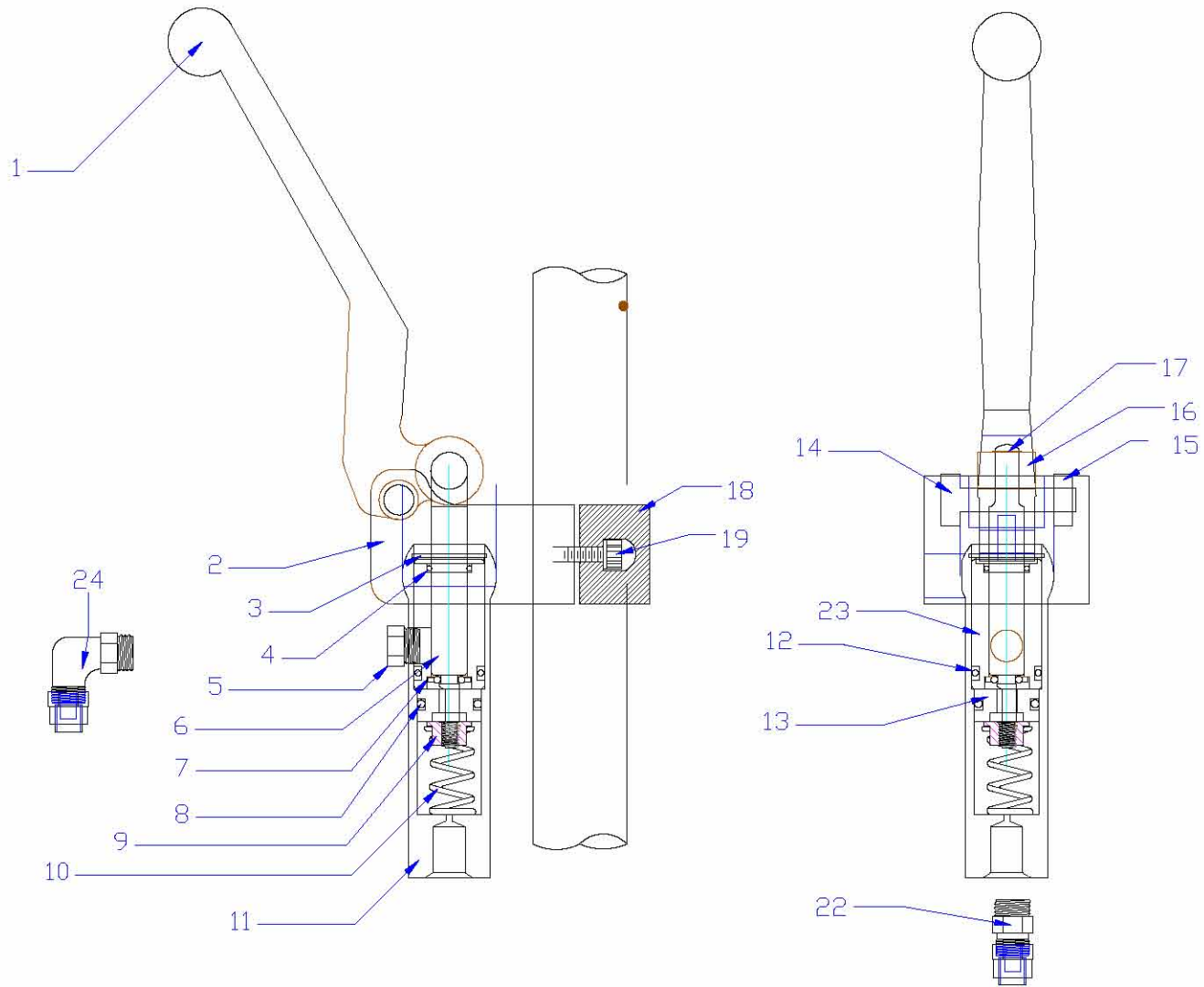

- FILL WITH MIL-H-5606 OR EQUIVALENT
- INITIAL BLEED PERFORMED BY PUMPING FLUID FROM CALIPER TO CYLINDER THRU #22 AND OUT FITTING #5 TO REMOTE RESERVOIR OR OTHER CYLINDER
- UNIT MAY BE MOUNTED IN ANY ORIENTATION, HOUSING MAY BE ROTATED AROUND SHAFT AXIS 360 DEG

MATCO mfg



2361 S 1560 West
WOODS CROSS, UT 84087

NOMENCLATURE
CYLINDER, HAND OPERATED MASTER

PART NUMBER
MC-7S

SCALE

MATERIAL

DRAWING NO.
MASTER/MC7S_INSTALL.DWG

REVISION
NC

TOLERANCES
(EXCEPT AS NOTED)
DO NOT SCALE DRAWING
LINEAR .XX = ±.03
.XXX = ±.01
ANGULAR ±1/2
CONCENTRIC ±.01

DRAWN BY
G. HAPP

FINISH
NONE

DATE
06/21/05

CHECKED BY
SHEET 1 OF 1
SHEET SIZE A