

REV E Add Configuration Note for WHLTWBL Base 8/1/08 GRH

| | | | |
|-----|-----------------------------|-------------------------------|-------|
| 1 | AXLE, VERTICAL | SEE CONFIGURATION NOTE | 1 |
| 2 | BUSHING | TW-19 | 2 |
| 3 | COTTER PIN ZINC | .11X1.5COTTERPIN | 2 |
| 4 | SPACER | BSP4 | 2 |
| 5 | BOLT | AN3-6 | 2 |
| 6 | WASHER | AN960-10 | 6 |
| 7 | NYLON WASHER | .750X.443X.062WASHER | 2 |
| 8 | WING, TAIL WHEEL | T-03**See Note on Alternate** | 2 |
| 9 | CASTLE NUT | AN310-3 | 2 |
| 10 | COTTER PIN ZINC | .062X.50COTTERPIN | 2 |
| 11 | SHCS (AXLE) | .50-13X3.50SHCS | 1 |
| 12 | FORK, 8" TAIL WHEEL | TW-8F | 1 |
| 13 | LOCK NUT | 10-24NYLOCK | 3 |
| 14 | BEARING, BALL .625 | SKF1623DCTN | 2 |
| 15 | BACK HALF, 4" TW, .625 BRNG | TW40EB/.625 | 1 |
| 16 | SLEEVE, .625 X .50 X 2 TUBE | T8SL | 1 |
| 17 | WASHER | .625 SAE | 2 |
| 18 | BASE, TAIL WHEEL | SEE CONFIGURATION NOTE | 1 |
| 19 | BUSHING, BRZ | SEE CONFIGURATION NOTE | 1 |
| 20 | ARM, TAIL WHEEL | T-02 | 1 |
| 21 | BUSHING BRZ | TW-21 | 1 |
| 22 | SHCS | .25-20X.50SHCS | 1 |
| 23 | HEX NUT SLOTTED | .62-18HEXNUT/SLOTTED | 2 |
| 24 | TIRE, 2.80/2.50 4PLY | T2.80/2.50-4 | 1 |
| 25 | TUBE 2.80-4 | TU2.80-4 | 1 |
| 26 | VALVE HALF, 4" TW .625 BRNG | TW40EV/.625 | 1 |
| 27 | SHCS | 10-24X.75SHCS | 3 |
| 28 | NYLOC NUT | .50-13NYLOC | 1 |
| NO. | PART NAME | INVENTORY NO. | REQ'D |
| 31 | FITTING, GREASE | SEE CONFIGURATION NOTE | 1 |
| 30 | CURVED SPRING WASHER | U625-0210 | 2 |
| 29 | BELLEVILLE WASHER | B0375-020 | 2 |

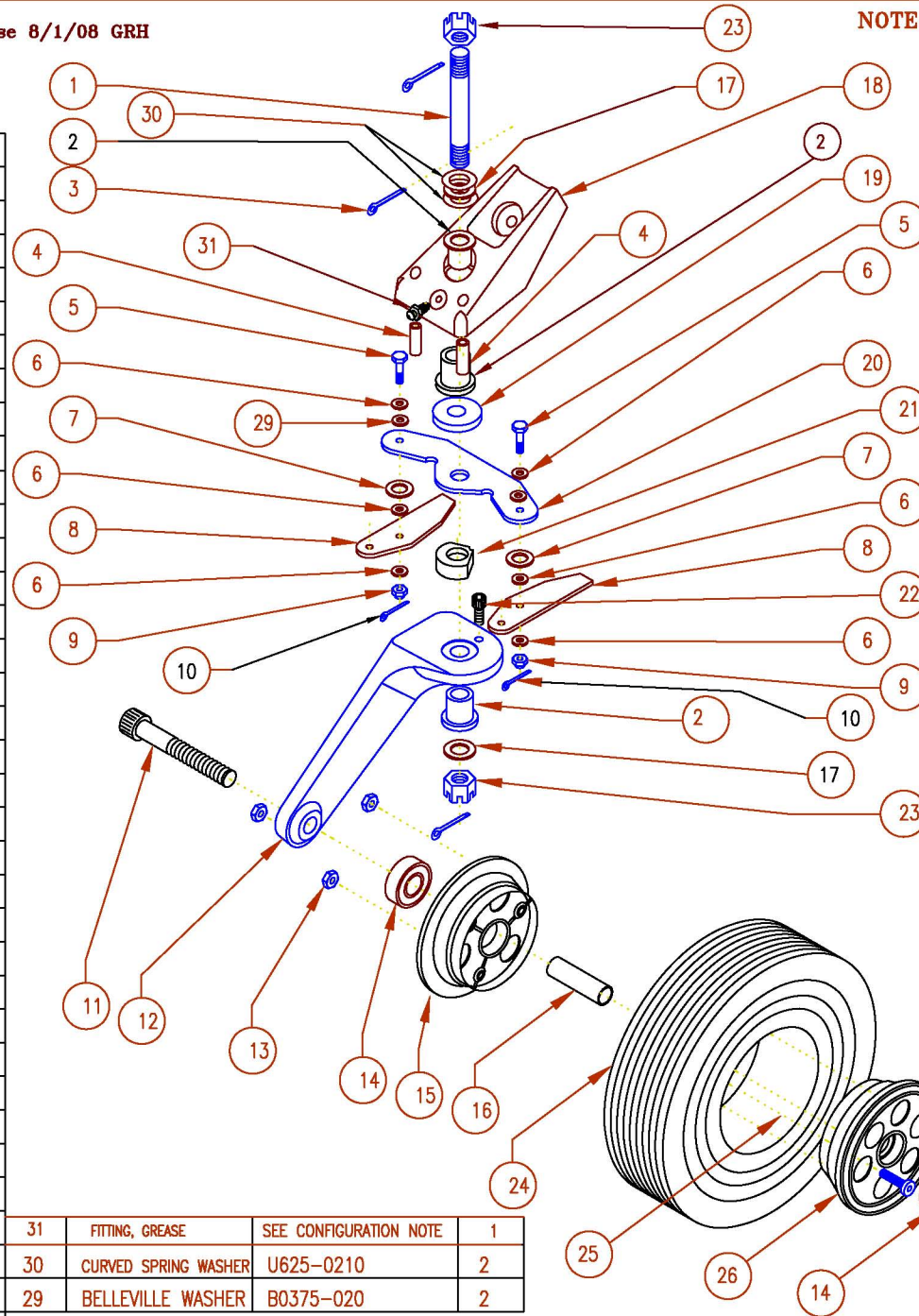

NOTE: Alternate Wing Available to Provide Earlier Steering Release. Part number T-03A Release with Standard T-03 = $\pm 45^\circ$ Release with T-03A = $\pm 25^\circ$ T-03A May Be Hand Ground to Angles between $\pm 25^\circ$ & $\pm 50^\circ$

To Set Preload In Vertical Axle #1: **Be Certain #30 Springs Are Installed.** Seat Upper Nut #23 Fully & Install Cotter Pin. Tighten Lower Nut #23 Slowly until All Freeplay of Springs #30 is Removed and Fork #12 No Longer Rotates Freely. Loosen Lower Nut #23 2-3 Locking Features and Install Cotter Pin. Fork Should Pivot Freely Around Complete Rotation

CONFIGURATION NOTE: Units made after 8/07 use the #18 TWBL which uses #31 grease fitting MSCMC7-4, #1 .625-18x4.35 Vertical Axle, 3 #2 TW-19, and #19 TW-4 washer. Units made before 8/07 use #18 TWB (no grease fitting provision), #1 .625-18x4BOLT(A), 2 #2 TW-19, and #19 TW-2 washer

T-8

DRAWN BY: GARY P. LANGFORD
MODIFIED BY:

SCALE: NONE
DATE: FEBRUARY 9, 2001

REVISION:
E

T8.DWG

MATCO mfg
2361 S 1560 West
WOODS CROSS, UT 84087 (801) 335-0582